

# De Rode Hoed

Tech sheet

Februari 2024

Table of content



# Amerpodia





## Adres, opening and closing hours

---

Keizersgracht 102, 1015 CV Amsterdam	<a href="#">Waze</a> / <a href="#">Maps</a>
Load in and out is at this adres and has a flat surface entrance into the main hall the rooms on the first and second floor can be reached via stairs.	
We have no parking options except for the loading area across our building to park here all day you can request a permit at the local authority's. Trucks and cars should park immediately after load out and not obstruct the canal longer than necessary . Latest option for load out is until 22.00.	<a href="#">Request a permit</a>
Nearest parking garage [P] Nieuwezijds Kolk 18, 1012 PV Amsterdam	<a href="#">Waze</a> / <a href="#">Maps</a>
<b>Opening and closing hours</b>	
On weekdays the event will need to end at 00:30 and all guests will have left the venue at 01:00 on Saturdays and Sundays the guests have to leave at 02:30 and the venue has to close at 03:00	
<b>Smoking and drinking</b>	
<b>Smoking is prohibited at Rode hoed.</b> To prevent neighbor nuisance a maximum of 10 people can smoke outside	
Glass is prohibited outside Rode Hoed	



## General information Oosterhuiszaal

---

### **Power**

63Amp at the entrance this socket is also patchable to the powerbox across the street to accommodate production trucks.

At the right hand side of the entrance of the Oosterhuiszaal there is a 125 plug but it has a 63 amp output.

On the 2nd balcony is a CCE form 32, 3 phases each fused at 16 amp

### **Lightruss**

Max load 500 kg per truss.

### **DB's**

The maximum level at de Oosterhuiszaal is 90dB(A) LAeq 15

### **Music**

In the public domain of de Rode Hoed, like the foyer, bar and reception, is amplified music no option.

It is however optional to have background music or the microphones from the main hall thru sealing speakers.

A presentation with small speakers on a stand is optional.



# Dimensions main hall & ground floor

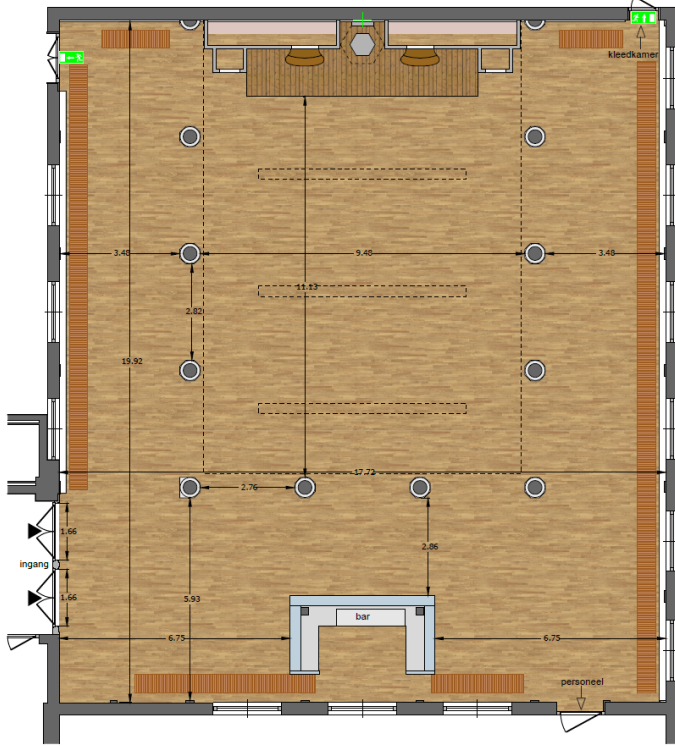

Oosterhuiszaal:  
begane grond

schaal 1:100

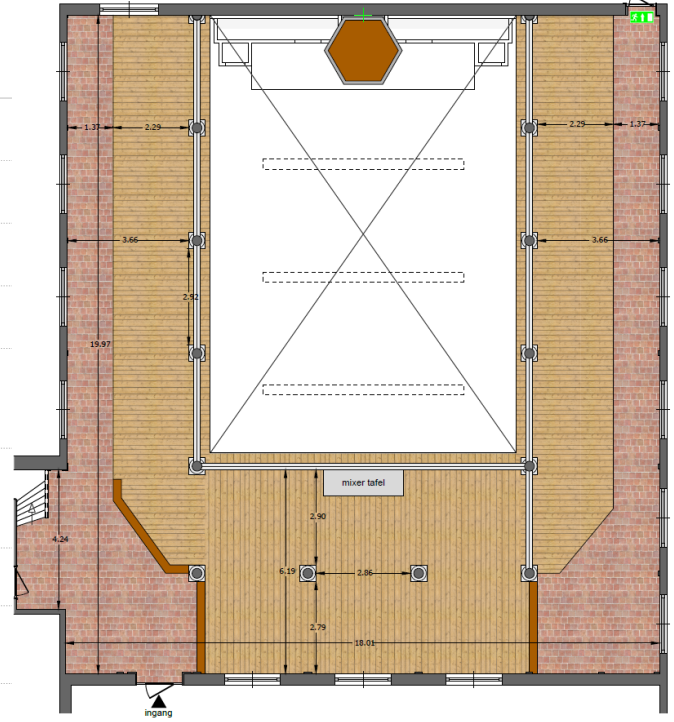
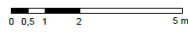

eerste balkon  
schaal 1:100

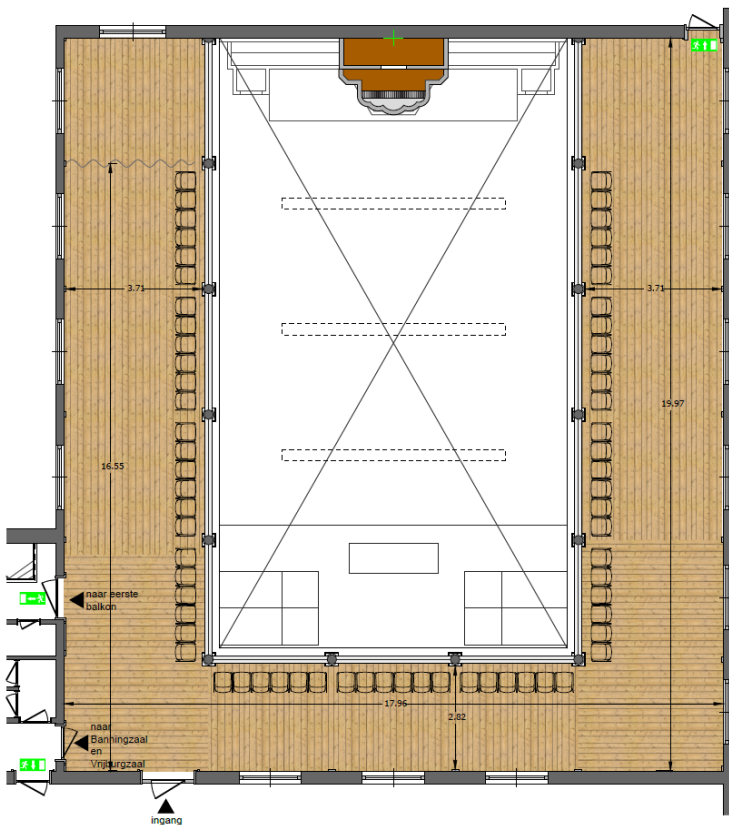

tweede balkon

schaal 1:100

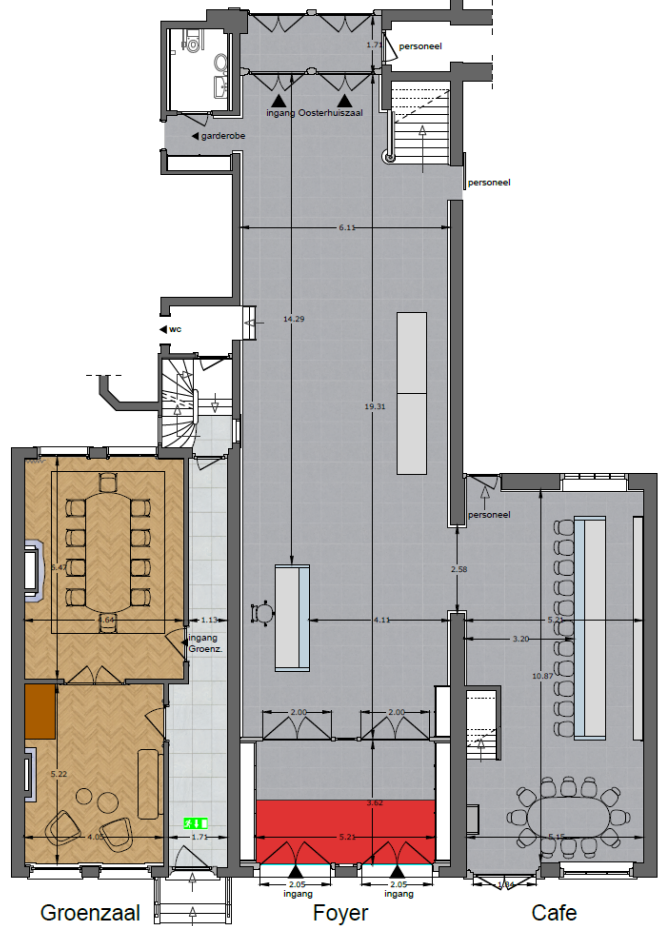

Groenzaal

Foyer

Cafe

schaal 1:100



## Audio specs Oosterhuiszaal

---

Main system	D&B C6 fullrange	2
Main system delay	D&B C6 fullrange	2
Main system delay	Meyer Sound UPJunior	2
Balkons	D&B E3	8
Sub	D&B B4	1
Amps	D&B Epac amplifiers 300 W	7
	D&B D12	1
Monitors	Nova KD 12 self powered	2
	D&B max 12 two way full range	2
FOH desk	Yamaha QL5	1
Processeor	Yamaha MRX7-D	1
Stagerack	Yamaha Rio 1608	1
Wireles	Shure ULXD 2	8 channels
	Shure QLXD 2	4 channels
Microfoons/beltpacks	Shure ULXD2 beta 58a	2
	Shure ULXD2 beta 87a	2
	Shure ULXD1 beltpack	6
	Shure QLXD SM 58a	3
	Shure QLXD 1 body pack	3
	Shure sm 58	4
	Neumann Km 184 stereo pair	1
	AKG CK 63 ULS condensator	4
	DPA 4066-OC-A-F00-LH	8
DI	Klark Teknik DN100 active mono di	4
Mike stands	K&M	4 regular 4 roundbase





# DMX Oosterhuiszaal

FixtureID	Name	Fixture Type	Univ.	Addr.
1	Dim 1	2 Dimmer 00	1	1
2	Dim 2	2 Dimmer 00	1	2
3	Dim 3	2 Dimmer 00	1	3
4	Dim 4	2 Dimmer 00	1	4
5	Dim 5	2 Dimmer 00	1	5
6	Dim 6	2 Dimmer 00	1	6
7	Dim 7	2 Dimmer 00	1	7
8	Dim 8	2 Dimmer 00	1	8
9	Dim 9	2 Dimmer 00	1	9
10	Dim 10	2 Dimmer 00	1	10
11	Dim 11	2 Dimmer 00	1	11
12	Dim 12	2 Dimmer 00	1	12
13	Dim 13	2 Dimmer 00	1	13
14	Dim 14	2 Dimmer 00	1	14
15	Dim 15	2 Dimmer 00	1	15
16	Dim 16	2 Dimmer 00	1	16
17	Dim 17	2 Dimmer 00	1	17
18	Dim 18	2 Dimmer 00	1	18
19	Dim 19	2 Dimmer 00	1	19
20	Dim 20	2 Dimmer 00	1	20
21	Dim 21	2 Dimmer 00	1	21
22	Dim 22	2 Dimmer 00	1	22
23	Dim 23	2 Dimmer 00	1	23
24	Dim 24	2 Dimmer 00	1	24
25	Dim 25	2 Dimmer 00	1	25
26	Dim 26	2 Dimmer 00	1	26
27	Dim 27	2 Dimmer 00	1	27
28	Dim 28	2 Dimmer 00	1	28
29	Dim 29	2 Dimmer 00	1	29
30	Dim 30	2 Dimmer 00	1	30
31	Dim 31	2 Dimmer 00	1	31
32	Dim 32	2 Dimmer 00	1	32
33	achter regie	14 Color Beam 14 FCW IR 4 Channel	2	113
34	achter regie	15 Color Beam 14 FCW IR 4 Channel	2	117
35	PAR Beneden	12 EPAR QA 3XXX	3	355
36	PAR Beneden	12 EPAR QA 3XXX	3	360
37	PAR Beneden	12 EPAR QA 3XXX	3	365
38	PAR Beneden	12 EPAR QA 3XXX	3	370
39	PAR Beneden	12 EPAR QA 3XXX	3	375
40	PAR Beneden	12 EPAR QA 3XXX	3	380
49	Goot rgbw	5 LED - RGBW 8 bit	2	25
50	Goot rgbw	5 LED - RGBW 8 bit	2	29
101	pilaar rgbw	6 TourLED Pro 28 Zoom ARC.2	2	33
102	pilaar rgbw	6 TourLED Pro 28 Zoom ARC.2	2	37
103	pilaar rgbw	6 TourLED Pro 28 Zoom ARC.2	2	41
104	pilaar rgbw	6 TourLED Pro 28 Zoom ARC.2	2	45
105	pilaar rgbw	6 TourLED Pro 28 Zoom ARC.2	2	49
106	pilaar rgbw	6 TourLED Pro 28 Zoom ARC.2	2	53
107	pilaar rgbw	6 TourLED Pro 28 Zoom ARC.2	2	57
108	pilaar rgbw	6 TourLED Pro 28 Zoom ARC.2	2	61





# DMX Oosterhuiszaal

FixtureID	Name	Fixture Type	Univ.	Addr.
109	pilaar rgbw	6 TourLED Pro 28 Zoom ARC.2	2	65
110	pilaar rgbw	6 TourLED Pro 28 Zoom ARC.2	2	69
111	pilaar rgbw	6 TourLED Pro 28 Zoom ARC.2	2	73
112	pilaar rgbw	6 TourLED Pro 28 Zoom ARC.2	2	77
113	pilaar rgbw	6 TourLED Pro 28 Zoom ARC.2	2	81
114	pilaar rgbw	6 TourLED Pro 28 Zoom ARC.2	2	85
115	pilaar rgbw	6 TourLED Pro 28 Zoom ARC.2	2	89
116	pilaar rgbw	6 TourLED Pro 28 Zoom ARC.2	2	93
117	pilaar rgbw	6 TourLED Pro 28 Zoom ARC.2	2	97
118	pilaar rgbw	6 TourLED Pro 28 Zoom ARC.2	2	101
119	pilaar rgbw	6 TourLED Pro 28 Zoom ARC.2	2	105
120	pilaar rgbw	6 TourLED Pro 28 Zoom ARC.2	2	109
201	Robe	9 Robin LedBeam 150 Mode 1	1	51
202	Robe	9 Robin LedBeam 150 Mode 1	1	73
203	Robe	9 Robin LedBeam 150 Mode 1	1	95
204	Robe	9 Robin LedBeam 150 Mode 1	1	117
205	Robe	9 Robin LedBeam 150 Mode 1	1	139
206	Robe	9 Robin LedBeam 150 Mode 1	1	161
207	Robe	9 Robin LedBeam 150 Mode 1	1	183
208	Robe	9 Robin LedBeam 150 Mode 1	1	205
209	Robe	9 Robin LedBeam 150 Mode 1	1	227
210	Robe	9 Robin LedBeam 150 Mode 1	1	249
211	Robe	9 Robin LedBeam 150 Mode 1	1	271
212	Robe	9 Robin LedBeam 150 Mode 1	1	293
221	Robe Kansel	7 Robin LEDBeam 150 Mode 1	3	21
222	Robe Kansel	7 Robin LEDBeam 150 Mode 1	3	43
231	Robe	9 Robin LedBeam 150 Mode 1	3	245
232	Robe	9 Robin LedBeam 150 Mode 1	3	267
233	Robe	9 Robin LedBeam 150 Mode 1	3	289
234	robe foor	7 Robin LEDBeam 150 Mode 1	3	311
235	robe foor	7 Robin LEDBeam 150 Mode 1	3	333
301	etc profiel	11 SourceFour LED Series 3 LustrX8	3	101
302	etc profiel	11 SourceFour LED Series 3 LustrX8	3	113
303	etc profiel	11 SourceFour LED Series 3 LustrX8	3	125
304	etc profiel	11 SourceFour LED Series 3 LustrX8	3	137
305	etc profiel	11 SourceFour LED Series 3 LustrX8	3	149
306	etc profiel	11 SourceFour LED Series 3 LustrX8	3	161
307	etc profiel	11 SourceFour LED Series 3 LustrX8	3	173
308	etc profiel	11 SourceFour LED Series 3 LustrX8	3	185
309	etc profiel	11 SourceFour LED Series 3 LustrX8	3	197
310	etc profiel	11 SourceFour LED Series 3 LustrX8	3	209
311	etc profiel	11 SourceFour LED Series 3 LustrX8	3	221
312	etc profiel	11 SourceFour LED Series 3 LustrX8	3	233
401	Rgba vloer	12 EPAR QA 3XXX	3	1
402	Rgba vloer	12 EPAR QA 3XXX	3	6
403	Rgba vloer	12 EPAR QA 3XXX	3	11
404	Rgba vloer	12 EPAR QA 3XXX	3	16





## Digital signing

---

**VIDEO:** Resolution: The maximum supported resolution is **1920x1080**.

Supported Codecs - H.265, H.264, MPEG-2

**Note:** .mov files with compressed "atoms" (i.e. metadata) are not currently supported.

Additionally Supported Extensions: Players also support .webm video with Vorbis audio (the Opus audio codec is not supported).

Specs for H.265 Extensions/Containers:

Specs for H.264 Extensions/Containers:

Support for Main and High profiles up to level 4.2

Maximum Recommended Video Bit Rate: 25Mbps

**AUDIO** **No Audio option available**

**IMAGE:** • Resolutie: **1920x1080**

• JPG

• BMP (8, 6, 24 of 32 bit)

• PNG 8, 16, 24 bit

**NOTE:** **IMPORTANT IS THE SIZE 1920X1080**

All content should be in our inbox 5 days prior to the event.



## Specs small rooms

---

<b>Keizerszaal</b>	Audio	Stereo active speakers auto on/off 4 audio inputs small mixer
	Projectie	Beamer Panasonic PT-VZ 580 Screen 180 wide variabele length Laptop on request Clicker
<b>Grachtenzaal</b>	Audio	Stereo active speakers auto on/off 4 audio inputs small mixer
	Projectie	Beamer Panasonic PT-VW340 Screen 180 wide variabele length Laptop on request Clicker
<b>Blauwe suite</b>	Audio	On request
	Projectie	Samsung 65" LCD scherm
<b>Amsterdam suite</b>	Audio	On request
	Projectie	Samsung 65" LCD scherm
<b>Groen suite</b>	Audio	On request
	Projectie	On request



# Stream hardware

# set 1

---

2 x 64 GB SD kaart
1 x 128 GB SD kaart
1 x 256 GB SD kaart
1 x Blackmagic Atem Television Studio HD
1 x Blackmagic Hyperdeck Studio HD Mini
1 x Harde Schijf 1TB
1 x Panasonic Remote Camera Controller AW-RP50
1 x Iiyama Monitor
2 x Aja U-tap
2 x Blackmagic Ultrastudio Mini Recorder
1 x Sennheiser HD 201 Koptelefoon
2 x Macbook
1 x HP Windows Laptop
1 x Blackmagic Micro Converter Bidirectional SDI/HDMI
2 x Blackmagic Updowncross convertor
1 x Behringer U-phoria UMC 22 Audio Interface
4 x Panasonic AW- HE130 RTP Camera's
4 x Statieven
1 x Audio Technica Pro 24 cm Mic
1 x Sidecom Switch
4 X Haspel BNC/UTP



# Stream Connections

## set 1

---

	Video Inputs 8
	Outputs 8
	Aux Outputs 1
	SDI Rates 270Mb, 1.5G, 3G.
	Audio Inputs 2 x XLR.
	Audio Outputs None, embedded audio only.
	Timecode Connections None.
	SDI Video Input 4 x 10-bit SD/HD switchable.
	Input 2 channel embedded audio.
	HDMI Video Input 2 channel embedded audio.
	Reference Input Tri-Sync or Black Burst.
	Video Input Re-Sync On all 8 inputs.
	SDI Program Output 5 x 10-bit SD/HD switchable.
	HDMI Program Output None.
	SDI Audio Output 2 Ch embedded into SDI output.
	Computer Output None.
	Qty of Multi-Views 1
	Outputs per Multi-View 1 x HD-SDI and 1 x HDMI.
	Control panel Ethernet supports 10/100/1000 BaseT. Allows direct connection between panel and chassis, or via network. Also used for updating the software.



# Stream Video Standards

set 1

---

	SD Format Support 525i59.94 NTSC 4:3 or 16:9, 625i50 PAL 4:3 or 16:9
	HD Format Support 720p50, 720p59.94, 1080p23.98, 1080p24, 1080p25, 1080p29.97, 1080p50, 1080p59.94, 1080i50, 1080i59.94
	Ultra HD Format Support none
	SDI Compliance SMPTE 259M, 292M and 424M.
	Video Sampling 4:2:2 10-bit
	Color Precision 4:2:2 10-bit
	Color Space 4:2:2 YUV
	HDMI Input Resolutions for Computers 720 x 480i 59.94Hz, 720 x 576i 50Hz, 1280 x 720p 59.94Hz 50Hz and 1920 x 1080p 23.98, 24, 25, 29.97, 30, 50, 59.94 and 1920 x 1080i 50 and 59.94Hz 60Hz.
	Colorspace Conversion Hardware based real time.
	Processing Delay 6 Lines.
	Audio Mixer 10 input x 2 channel mixer. Selectable On/Off/Audio-Follow-Video.
	Level and Peak metering. Master gain control. Headphone output level control with separate mix of Program, Talkback and Sidetone.



## Stream hardware

set 2

---

1 x 64 GB SD kaart
1 x 128 GB SD kaart
1 x Blackmagic Atem Production Studio 4k
1 x Blackmagic Hyperdeck Studio HD Mini
1 x Harde Schijf 2TB
1 x JVC Remote Camera Controller RM-LP100
1 x Monitor
1 x Aja U-tap
2 x Blackmagic Ultrastudio Mini Recorder
1 x Sennheiser HD 201 Koptelefoon
1 x Macbook
1 x Mac mini
1 x Blackmagic Micro Convertor Bidirectional SDI/HDMI
1 x Blackmagic Updowncross convertor
1 x Asus 13" monitor
3 x JVC PTZ Remote Camera's
3 x Manfrotto Statieven
1 x Netgear Switch
3 X Haspel BNC/UTP
1 x Stream Deck





# Stream Connections

## set 2

	Video Inputs 8
	Outputs 6
	Aux Outputs 1
	SDI Video Input: 4 x 10-bit SD/HD/Ultra HD 4K switchable. 2 channel embedded audio.
	HDMI Video Input: 4 x HDMI type A, 10-bit SD/HD/Ultra HD 4K switchable. 2 channel embedded audio.
	Analog Audio Output : 2 x XLR
	SDI Audio Output: 2 channel embedded into SDI output.
	Audio Input: 2 x XLR. 2 x RCA.
	Sync Input: Tri-Sync or Black burst.
	SDI Program Output: 1 x 10-bit SD/HD/Ultra HD 4K switchable
	HDMI Program Output: 1 x HDMI type A, 10-bit SD/HD/Ultra HD 4K switchable.
	Down Converted SDI Program Output: 1 x 10-bit HD (Ultra HD 4K to HD).
	SDI Aux. Output: 1
	Quantity of Multi Views: 1
	Outputs per Multi View: 1 x HD-SDI and 1 x HDMI
	Control Panel Connection: Ethernet supports 10/100/1000 BaseT. Allows direct connection between panel and chassis, or via network.
	Extra: 6 x UTP, 1x HDMI 5 OUT, 1 x HDMI 6 OUT



# Stream Video Standards

## set 2

---

	SD Format Support 525i59.94 NTSC 4:3 or 16:9, 625i50 PAL 4:3 or 16:9
	HD Format Support 720p50, 720p59.94, 1080p23.98, 1080p24, 1080p25, 1080p29.97, 1080p50, 1080p59.94, 1080i50, 1080i59.94
	Ultra HD Format Support none
	SDI Compliance SMPTE 259M, 292M and 424M.
	Video Sampling 4:2:2 10-bit
	Color Precision 4:2:2 10-bit
	Color Space 4:2:2 YUV
	HDMI Input Resolutions for Computers 720 x 480i 59.94Hz, 720 x 576i 50Hz, 1280 x 720p 59.94Hz 50Hz and 1920 x 1080p 23.98, 24, 25, 29.97, 30, 50, 59.94 and 1920 x 1080i 50 and 59.94Hz 60Hz.
	Colorspace Conversion Hardware based real time.
	Processing Delay 6 Lines.
	Audio Mixer 10 input x 2 channel mixer. Selectable On/Off/Audio-Follow-Video.
	Level and Peak metering. Master gain control. Headphone output level control with separate mix of Program, Talkback and Sidetone.



## Instruments

---



Yamaha Piano  
Tuned at 440 Hz  
Grachtenzaal



Yamaha C7 Vleugel  
Tuned to 440 Hz  
Oosterhuiszaal



Organ  
Oosterhuiszaal

## DJ set

---

Pioneer XDJ-RX3	<a href="#"><u>Pioneer XDJ-RX3 specs</u></a>
2 X Powered monitor on dj boot output	<a href="#"><u>Nova KD 12 self powered</u></a>